



TX 230

LEVELLING ON ALL SUBSTRATES IN FACADES OR COVERING CERAMIC TILES

EXTERIOR & INTERIOR USE

APPLICATION PROCESS



1

Preparing the substrate

Remove dust from the portion to be filled.
Surfaces must be hard, clean, cohesive, sound and dry.



2

Preparing the filler

TX 230 is a ready to use filler.



3

Applying the filler

- Apply the coating with a coating knife or trowel. On ceramic tiles, it is always recommended to make the first coat a thin layer.
- Smooth over with a 50 cm blade so as to cover any defaults in the substrate up to 3 mm.
- If necessary, apply a second coat when the first is completely dry.

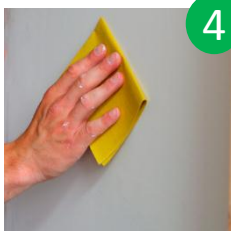

4

Finishing work

Sand as soon as the surface is dry.

Overcoating

Paint over, with all types of conventional paints.

For more details, please refer to datasheets