

HIGH GLOSS Surfacer

ACHIEVE GLOSS OR SILK FINISHES

INTERIOR USE



APPLICATION PROCESS

1

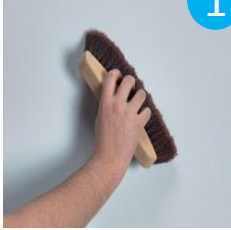

Preparing the substrate

Clean the substrate and remove dust. Surfaces must be hard, cohesive, clean, sound and dry.

2



Preparing the filler

High-Gloss is a ready to use filler.

3

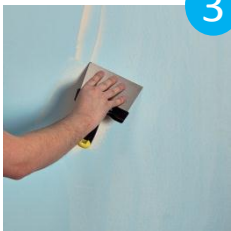

Applying the filler

- Remove the yellowish liquid substance from the product surface before use. Apply the product into several successive very thin coats. Spread the filler with a 20 cm blade into thin coats over the surface by areas of approximately 1 m². Remove the product excess by holding the blade at an angle of minimum 45° to the wall.

- Apply a second coat, if necessary.

4

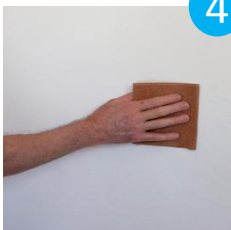

Finishing work

Sand after the filler is completely dry to eliminate irregularities on the surface. It is recommended to use sand papers 400 to 600 Grit.

Overcoating

Paint over with any conventional paint or cover with wall paper.

For more details, please refer to datasheets

TOUPRET S.A
24, rue du 14 juillet
91813 Corbeil-Essonnes
Cedex - France
www.toupret.com

SOLEBAT ME LLC
City Tower 2, office 1605 - Sheikh Zayed Road,
PO Box 191528, Dubai
United Arab Emirates
Tel : 00971 45547461 - Email : toupretuae@toupret.com

SOLEBAT S.A.R.L
Rue Moussaitbé
PO Box :14-5592, Beirut Lebanon
Tel : +961 1 305649 -306966- 303414
Fax : +961 1 816428
Email : toupretme@toupret.com

TOUPRET
FILLERS FOR DECORATORS